

## About the Rapid Bracket - Void Detector Holder

The Patented Rapid Bracket is a proudly Australian Made Void Detector Holder. It allows the easy installation and future maintenance of detectors in inaccessible or hard to reach ceiling spaces from 550mm to 3000mm in height. Using the Rapid Bracket avoids the need for access hatches, leaving a sleek aesthetically pleasing finish.

Constructed from ultra-high heat resistant engineering polymers and ultra-light weight anodized aluminium, the Rapid bracket weighs just 1.25kg in its tallest form. Its 128mm opening means it can be used with a larger variety of detectors. The clever clamping design allows it to be used in ceiling thicknesses ranging from 8mm to 32mm, and gives it the additional ability to be back blocked for some of those lighter duty ceilings or ceiling tiles. Designed for rapid installation straight from the box.

### Safety



Always wear appropriate personal protective equipment when installing or servicing this device. Beware of hazards like electrical cables or other services when using this product. This product must be installed & serviced by competent persons. The Rapid Bracket must be installed in conjunction with the *Product Installation Specifications*

### 3 Year Replacement Warranty

In order to make a claim under this warranty, return the product to your place of purchase. DynamicPro Rapid Bracket reserves the right to change the information contained in this document without notice. To ensure you have the most up to date information please contact [info@dynamicpro.ca](mailto:info@dynamicpro.ca)

Rapid Bracket is not liable for representations made by users, suppliers, or retailers about the product. Rapid Bracket is not liable for any loss or damage resulting from incorrect, careless or negligent use or storage of the product. To the maximum extent permitted by law Rapid Bracket disclaims all warranties in relation to manufacture and use of the product. Rapid Bracket does not exclude rights and remedies that cannot be excluded by legislation. Any liability arising from use of the product is limited to the replacement or purchase price of the product.

## CONTACT

**DynamicPro**  
Technology Management Inc.

Unit 157-99 Scurfield Blvd.,  
Winnipeg, MB, R3Y 1Y1, Canada.

✉ [info@dynamicpro.ca](mailto:info@dynamicpro.ca)

🌐 [www.dynamicpro.ca](http://www.dynamicpro.ca) ☎ +1 204 306-5173

Ref. DP-RapidBracket/RBVDHFR/V1.0/150324



# DYNAMICPRO

## RAPID BRACKET

### VOID DETECTOR HOLDER

## INSTALLATION MANUAL

Part No: RBVDHFR

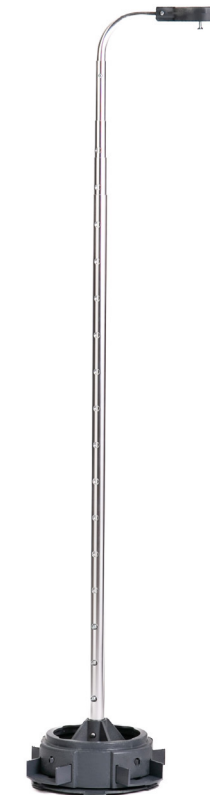

# DynamicPro Rapid Bracket Void Detector Holder Installation Instructions

## STEP 1

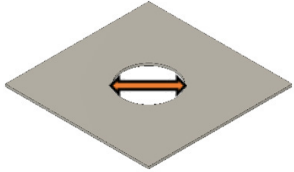

Cut a 165mm hole.

## STEP 2

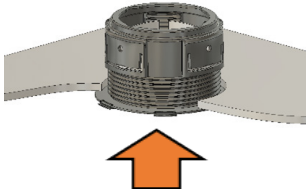

Insert the *Rapid Bracket* into the ceiling.

## STEP 3

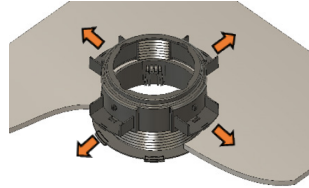

Push clips out until they **CLICK** into place.

## STEP 4

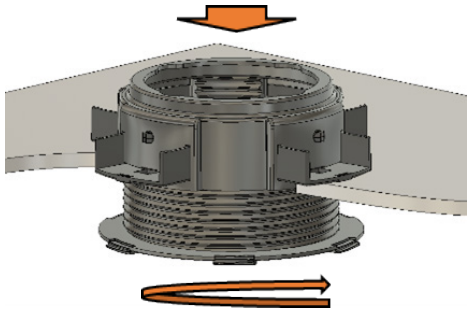

Seat the bracket into the hole and tighten.

## STEP 5

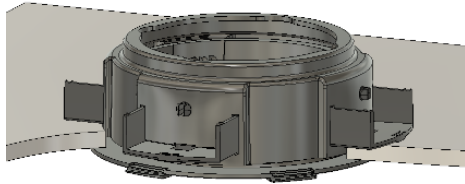

Complete.

## STEP 6



Insert Tubes into the Tube holder, the Bend Piece and Detector Holder.

## STEP 7

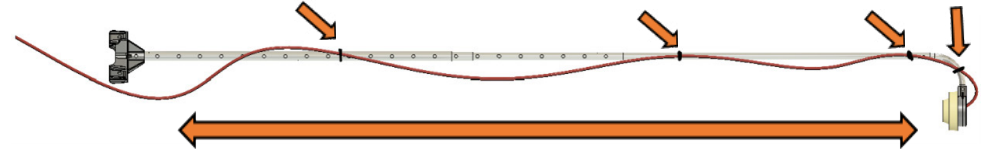

Extend Tubes to desired length. Then, cable tie your cables to the Tubes and fit off your Device.

## STEP 8



Use the Assistance Handle to assist with balance.

## STEP 9

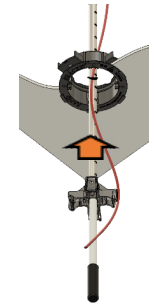

Insert through hole.

## STEP 10

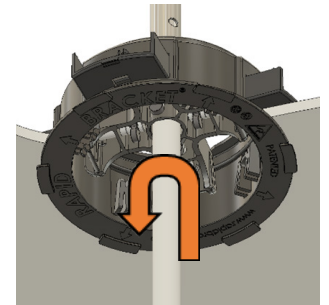

Push up, twist and sit down over wedges.

## STEP 11

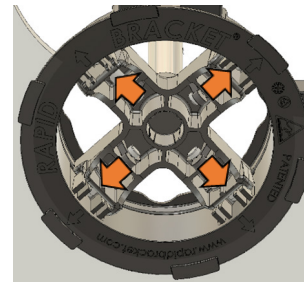

Push out 4x locking pins.

## STEP 12

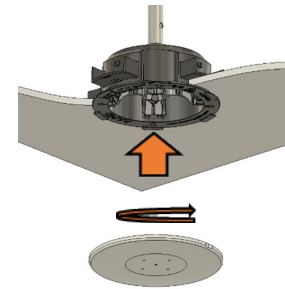

Clip on lanyard and twist on faceplate.

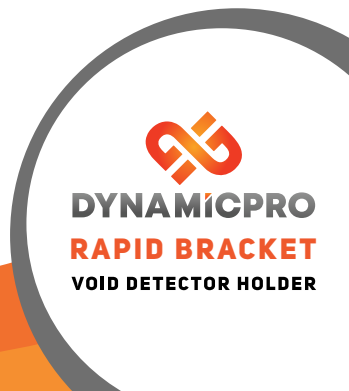

**DYNAMICPRO**  
**RAPID BRACKET**  
**VOID DETECTOR HOLDER**